

S³ TECHNOLOGIES WALL FINISHING SYSTEMS

PREMIUM QUALITY WALL FINISHING
LONG LASTING & SMOOTH FINISHING SOLUTION

BRICK WALL (CLAY/CEMENT SAND BRICK)

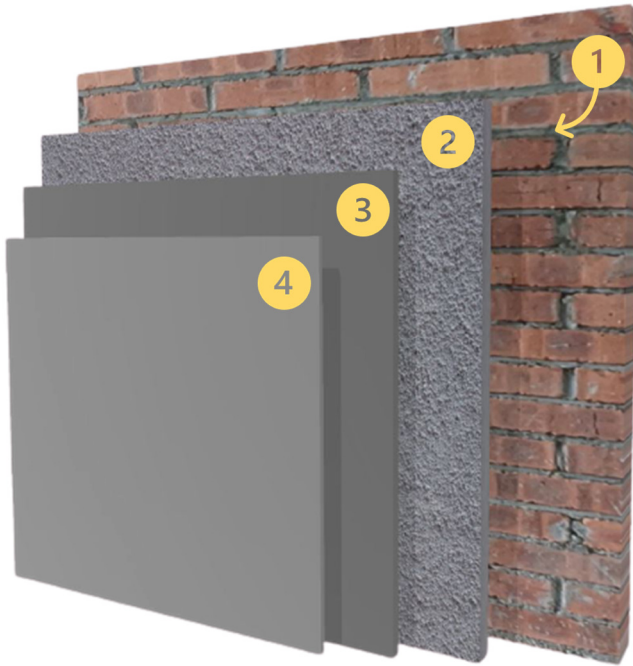

INTERNAL

- ① PrimeMix 99 (Thick Plaster) *1
- ② PrimeMix 99 (Thick Plaster)
- ③ SmartCote 61/62/60 (Base Skim Coat) *2
- ④ SmartCote 50/72 (Finish Skim Coat) *3

EXTERNAL

- ① PrimeMix 99 (Thick Plaster) *1
- ② PrimeMix 99 (Thick Plaster)
- ③ SmartCote 61/62/60 (Base Skim Coat) *2
- ④ SmartCote 50/72 (Finish Skim Coat) *3

No.	Internal		External
1	10 mm thickness (PrimeMix 99)	BL	10 mm thickness (PrimeMix 99)
2	20 mm thickness (PrimeMix 99)	P	20 mm thickness (PrimeMix 99)
3	2 – 3 mm thickness (SmartCote 61/62/60)	B	2 – 3 mm thickness (SmartCote 61/62/60)
4	1 – 2 mm thickness (SmartCote 50/72)	F	1 – 2 mm thickness (SmartCote 50/72)

Consumption of materials :

PrimeMix 99	0.6m ² /kg/mm thickness
SmartCote 61/62/60	0.65m ² /kg/mm thickness
SmartCote 50/72	0.75m ² /kg/mm thickness

Remarks :

The wall system solutions proposed in this guide serves as a recommendation guide which is specially designed to meet the highest standard of architectural construction requirements against **CONQUAS** Construction Quality Assessment System, which is intended to be applied with good engineering and workmanship practices in accordance to the manufacturer's instructions.

System solutions may vary according to each project's design & requirements.

*1 – To be laid in full mortar bed, including mesh reinforcement in the mortar joints at every 4th course of brickwork. Manufacturer must comply to approved International Quality System (ISO9000 Series) and approved Environmental Management System (ISO14000 Series)

*2 – SmartCote 61/60 is Grey colour, SmartCote 62 is White colour. Selection of SmartCote 61/62 & 60 depends on **texture requirements** of the client.

*3 – SmartCote 50 is Grey colour, SmartCote 72 is White colour

Good wall finishing system guidelines :

- BL Step 1 – Brick Laying
- P Step 2 – Plastering
- B Step 3 – Base Skim Coat
- F Step 4 – Finish Skim Coat